



**TECHNISCHE
UNIVERSITÄT
DRESDEN**

DRESDEN
concept



Department of Computer Science Institute for System Architecture, Chair for Computer Networks

Application Development for Mobile and Ubiquitous Computing

Seminar Task

Adaptation Concept Presentation

Group No. 2
Team: EVRARD-PION

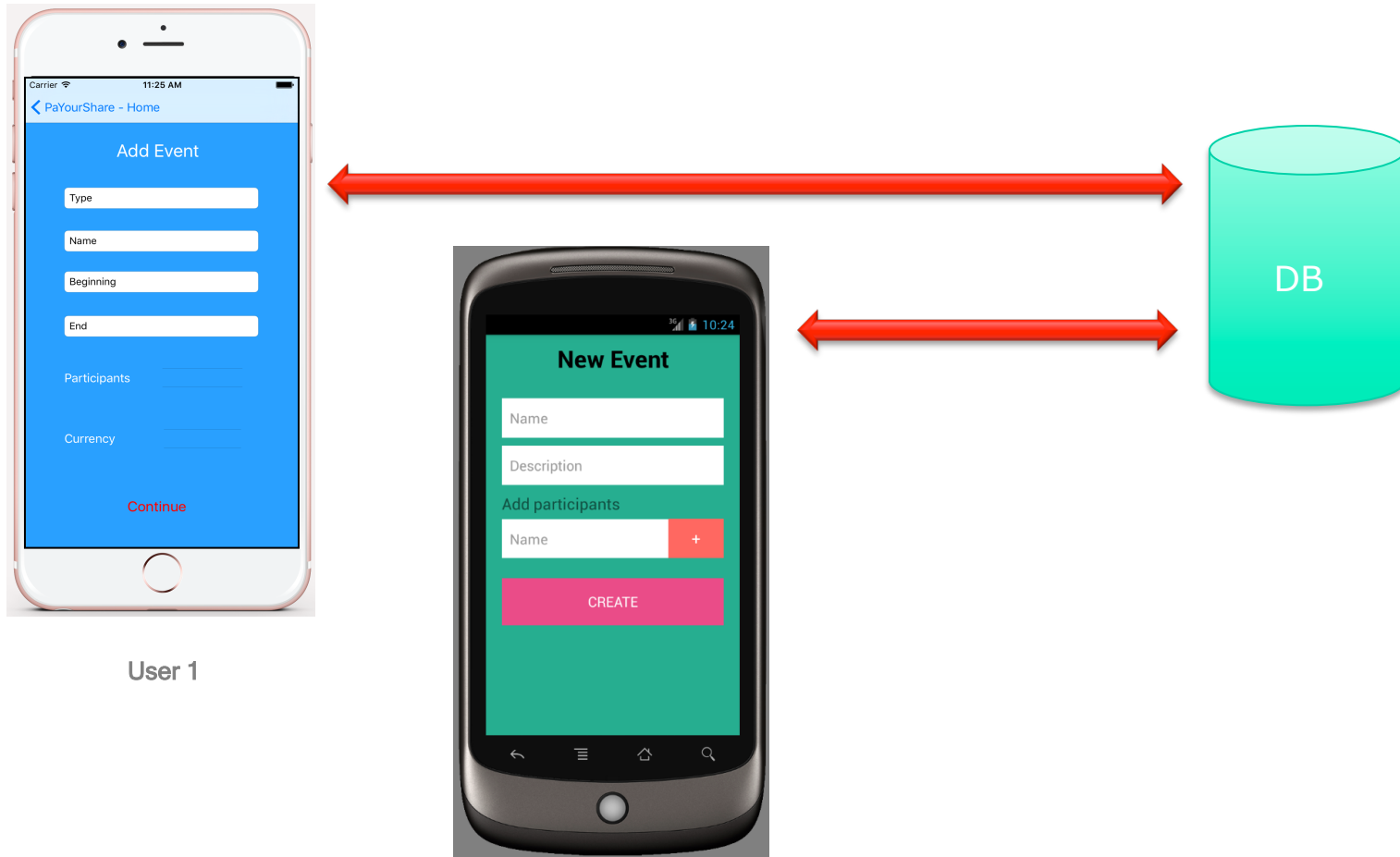

User 1

User 2

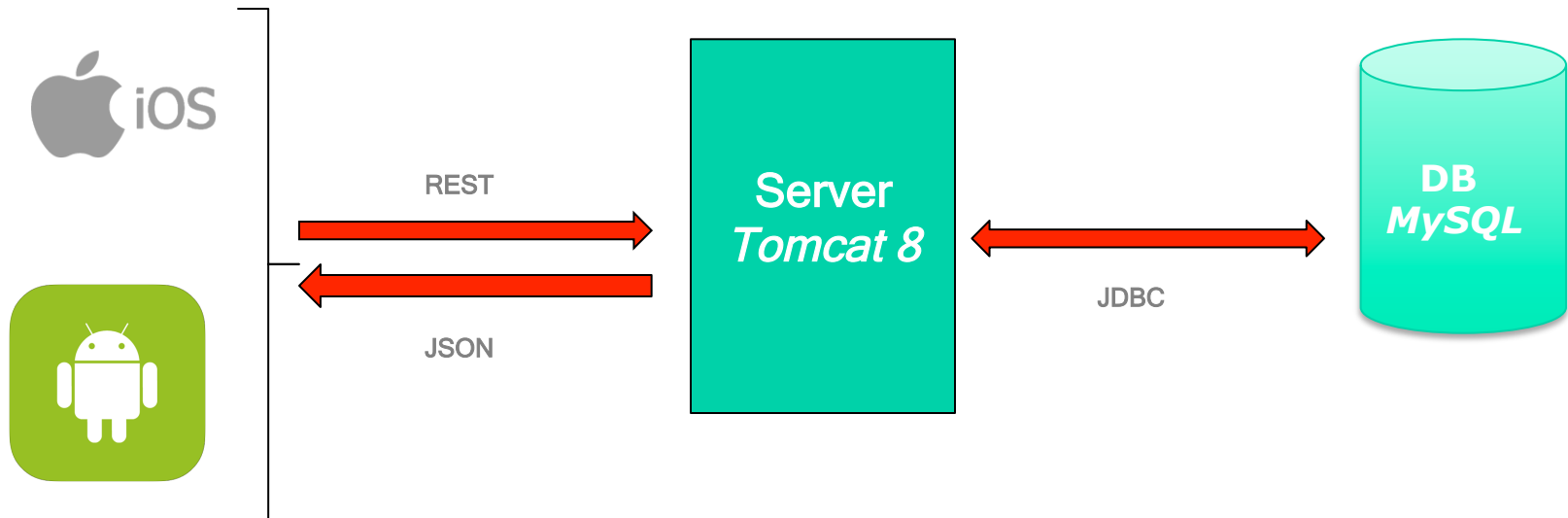

- **Multiplatforms :**

- App usable on iOS and Android,
- Xamarin + Android Studio,



- **Offline Challenge :**

- Detect when the device is connected to the Web or not,
- Use of cached or updated data depending on the current connection,

- **Usability challenge :**

- Minimize efforts for user,
- Keep good interface by adapting layout.

- **Offline Mode (Account required) :**
 - Create event and expenses,
 - Simple calculation,
 - **Online Mode :**
 - Synchronisation when app is launched and closed,
 - Pop Up when connection lost.
- *Adapt the app depending on the connection of the device,*
- *API to detect the connection and deactivate/activate functions of the app (Reachability on iOS or NetworkInfo on Android).*
- **Keeping a good interface :**
 - Depending on the phone, the app should automatically adapt to the layout,
 - Work on a large amount of smartphone.
- *Adapt to screen size of the device,*
- *AutoLayout on iOS or DIP on Android.*



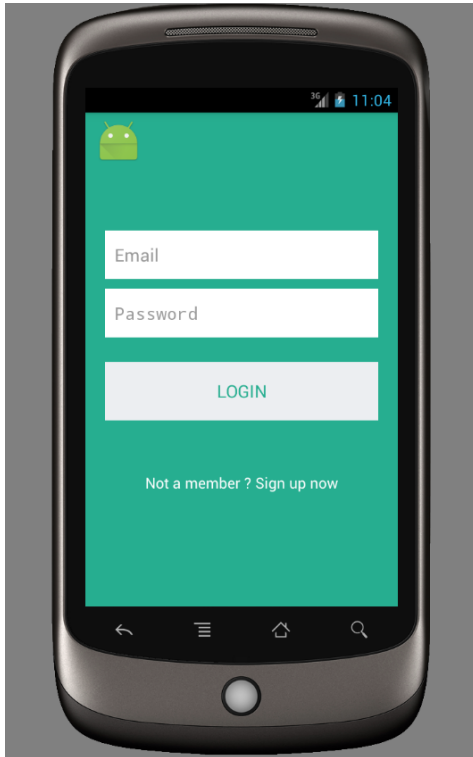

Connection

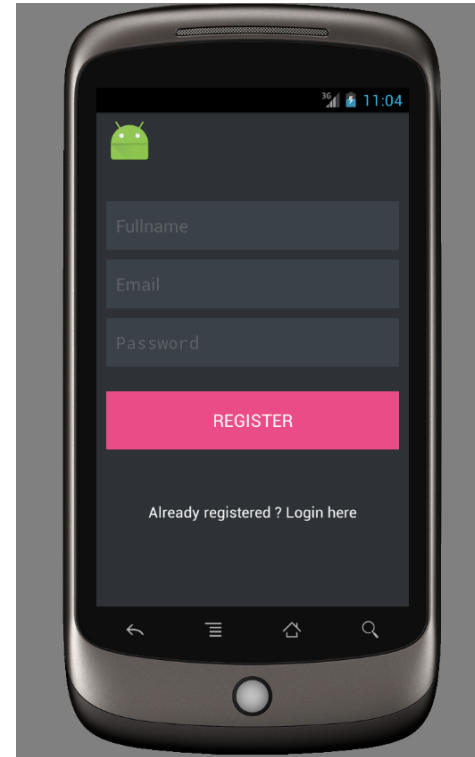
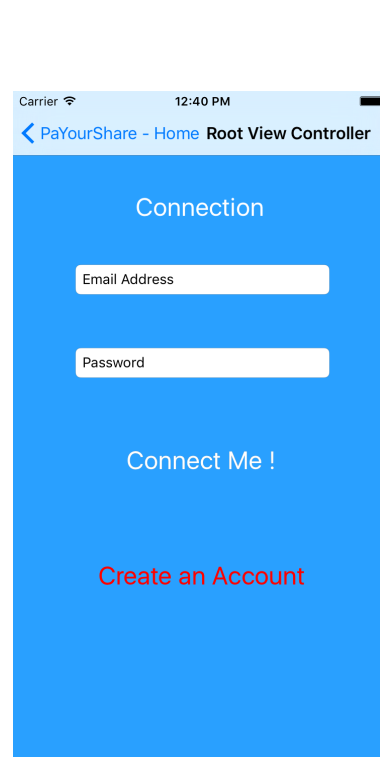

Create an account

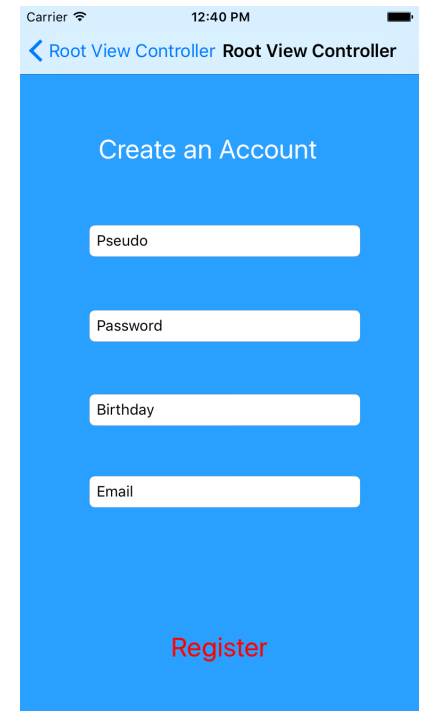



Event & Details

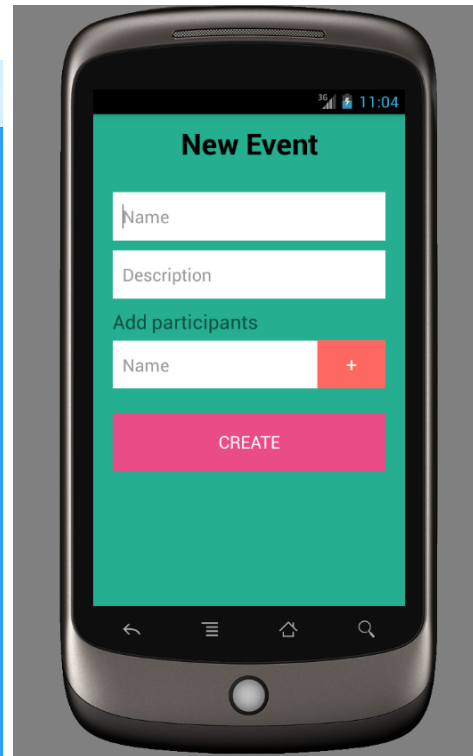
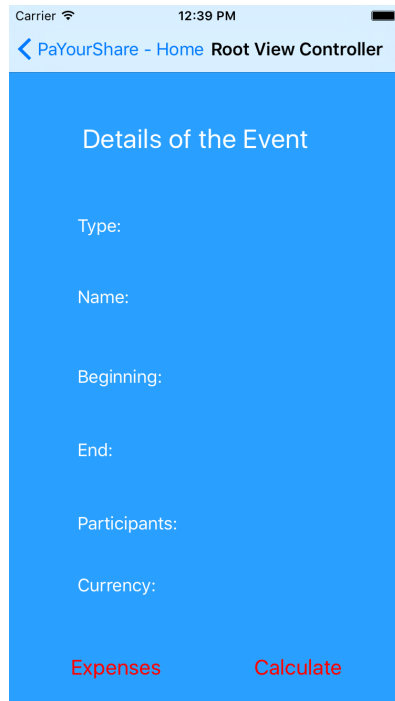

Add an Event

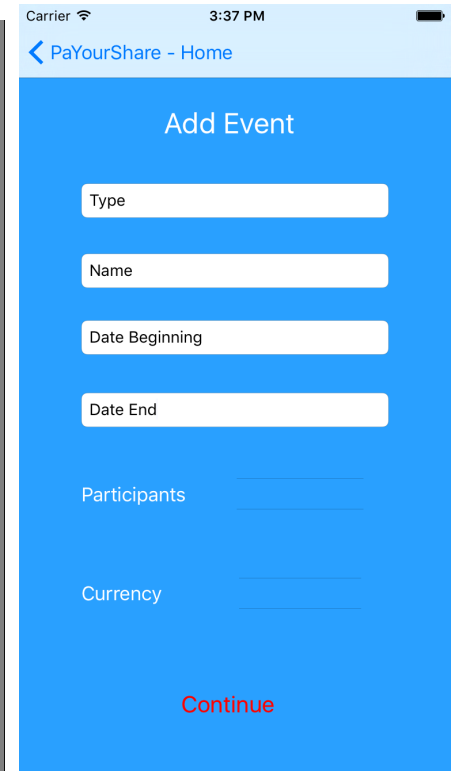

What is next ?

